

Hygiene corner valve 6052

with 3A compliance

DN 15 to DN 50



Pneumatic control valve in angle valve design. For dairy applications as well as for applications in pharmaceutical, food and beverage technology



- Integrated positioner type 8049 (or as shut-off valve)
- Perfect cleanability thanks to optimized flow behavior with regard to constantly high wall shear stresses
- 3A authorized valve design for easy CIP/SIP cleaning
- Housing made of non-porous solid material
- Sealing of the medium by a membrane
- Stable membrane construction for extreme temperature fluctuations
- Highest chemical resistance due to PTFE film on the diaphragm
- Simple construction principle
- Customer-friendly maintenance
- Components in contact with media with FDA conformity and according to the guidelines (EG) 1935/2004 and (EU) 10/2011
- Available with spring open function for CIP/SIP cleaning with depressurized actuator
- Also suitable for vacuum applications



Specifications valve

housing material	Stainless steel 1.4435	
nominal widths	DN 15 to DN 50	
connections	Welding ends according to ASME BPE OD-tubing clamp sockets according to ASME-BPE	
nominal pressure	PM 16	
membrane	Reinforced EPDM membrane with PTFE foil (media side)	
media temperature	- 20°C to +140°C	
rangeability	50:1	
vacuum	maximum 0.001 bar abs	
hysteresis	< 0.5%	
Surfaces in contact with media	Ra 0.6 µm electropolished Ra 0.4 µm (optional for housing)	
surfaces outside	housing parts:	Ra 1.2 µm
	Piston drives:	Cast surface (standard) polished Ra 0.8 µm (optional)
	Diaphragm actuators:	Deep drawn sheet metal polished Ra 0.8 µm (optional)
Leakage according to EN 12266-1	Leakage class A	

positioner

For the technical data of the positioner, please refer to the data sheet for type 8049

materials

valve body	Stainless steel 1.4435
drive	Stainless steel 1.4408 (optionally polished)
diaphragm drive	Stainless steel 1.4301 (optionally polished)
drive springs	1.4310 stainless steel
Valve stem	Stainless steel 1.4571
Control cone/seat seal	PEEK
clamp connection	Stainless steel 1.4435
Housing positioner	Aluminum, plastic, optional: stainless steel 1.4305
Housing position indicator	PA Polyamide (clear)

with 3A compliance

Permissible differential pressures

Pressure values for control valves with positioner type 8049

				Max. operating pressure P1 [bar] (depending on the downstream pressure P2 [bar])																										
DN	drive	feathers	P _{Tax} [bar]	p2	0	1	2	2.1	2.2	2.3	2.4	2.5	2.6	2.7	2.8	2.9	3	4	5	6	6.1	6.2	6.3	6.4	6.5	6.6	6.7	6.8	6.9	
15	D80	2	5 to 6	max P1	10	10	10	10	10	10	10	9.8	8.3	6.9	5.4	3.9														
	D125	3	4 to 6	max P1	10	10	10	10	10	10	10	10	10	10	10	10	10	10	10	10	10	10	10	10	10	10	10	10	10	10
20	D80	2	5 to 6	max P1	10	10	10	10	10	10	10	9.8	8.3	6.9	5.4	3.9														
	D125	3	4 to 6	max P1	10	10	10	10	10	10	10	10	10	10	10	10	10	10	10	10	10	10	10	10	10	10	10	10	10	10
25	D80	2	5 to 6	max P1	10	9.8	9.3	8.3	7.3	6.4	5.4	4.4	3.4	2.4	1.9															
	D125	3	4 to 6	max P1	10	10	10	10	10	10	10	10	10	10	10	10	10	10	10	10	10	10	10	10	10	10	10	10	10	10
	D250	6	3 to 6	max P1	10	10	10	10	10	10	10	10	10	10	10	10	10	10	10	10	10	10	10	10	10	10	10	10	10	10
40	D125	3	4 to 6	max P1	10	10	9.9	9.4	9	8.5	8th	7.5	7	6.5	6	5.5	5	4.5	4	3.8										
	D250	6	3 to 6	max P1	10	10	10	10	10	10	10	10	10	10	10	10	10	10	10	10	10	10	9.9	9.7	9.4	9	8.5	8th	7.5	7
50	D125	3	4 to 6	max P1	5.9	5.6	5.3	5.1	5	4.7	4.4	4.1	4	3.8	3.7	3.5	3.2	2.9	2.6	2.5										
	D250	6	3 to 6	max P1	7.5	7.5	7.5	7.5	7.5	7.5	7.5	7.5	7.5	7.4	7.2	7.2	6.8	6.5	6.2	6	5.9	5.6	5.3	5	4.7	4.4	4.4	4		
65	125	3	4 to 6	max P1	2.6	2.4	2.3	2.2	2.1	2	1.9	1.8	1.7	1.6	1.4	1.3														
	250	6	3 to 6	max P1	3	3	3	3	3	3	3	2.9	2.8	2.7	2.6	2.5	2.4	2.2	2.1	2	1.9	1.8								

Also suitable for vacuum applications

Pressure values for shut-off valves (spring closes*)

				Max. operating pressure P1 [bar] (depending on the downstream pressure P2 [bar])																										
DN	drive	feathers	P _{Tax} [bar]	p2	0	1	2	2.1	2.2	2.3	2.4	2.5	2.6	2.7	2.8	2.9	3	4	5	6	6.1	6.2	6.3	6.4	6.5	6.6	6.7	6.8	6.9	
15	D80	2	4.8 to 10	max P1	14	14	14	14	14	12.5	11	9.8	8.3	6.9	5.4	3.9														
	D125	3	3.1 to 10	max P1	14	14	14	14	14	14	14	14	14	14	14	14	14	14	14	14	14	14	14	14	14	14	14	14	14	
20	D80	2	4.8 to 10	max P1	14	14	12.5	11	9.8	8.3	6.9	5.4	3.9																	
	D125	3	3.1 to 10	max P1	14	14	14	14	14	14	14	14	14	14	14	14	14	14	14	14	14	14	14	14	14	14	14	14	14	
25	D80	2	4.8 to 10	max P1	10	9.8	9.3	4.3	7.3	6.4	5.4	4.4	3.4	2.4	1.9															
	D125	3	3.1 to 10	max P1	14	14	14	14	14	14	14	14	14	14	14	14	14	14	14	14	14	14	14	14	14	14	14	14	14	
	D250	6	2.2 to 6	max P1	14	14	14	14	14	14	14	14	14	14	14	14	14	14	14	14	14	14	14	14	14	14	14	14	14	
40	D125	3	3.1 to 10	max P1	11	10.7	10.4	9.9	9.4	9.2	9	8.7	8.5	8th	7.7	7.5	7	6.5	6	5.5	5	4.5	4	3.8						
	D250	6	2.2 to 6	max P1	11	11	11	11	11	11	11	11	11	11	11	11	11	11	11	11	11	11	11	11	11	11	11	11	11	
50	D125	3	3.1 to 10	max P1	5.9	5.7	5.6	5.1	5	4.7	4.4	4.1	3.8	3.7	3.5	3.2	2.9	2.6	2.5											
	D250	6	2.2 to 6	max P1	9	9	9	8.7	8.5	8.2	8th	7.7	7.4	7.2	7.2	6.8	6.5	6.2	6	5.9	5.7	5.3	5	4.7	4.4	4.3	4.4	3.8		
65	125	3	3.1 to 10	max P1	2.6	2.4	2.3	2.1	2	1.9	1.7	1.6	1.4	1.3																
	250	6	2.2 to 6	max P1	3.1	3.1	3.1	3.1	3	2.9	2.7	2.6	2.5	2.4	2.2	2.1	2	1.9	1.8											
	250	8th	2.7 to 6	max P1	3.1	3.1	3.1	3.1	3.1	3.1	3.1	3.1	3.1	3.1	3.1	3.1	3.1	3.1	3.1	3.1	3.1	3.1	3.1	3.1	3.1	3.1	3.1	3.1	3.1	

* Pressure values for "spring opens" on request
 Also suitable for vacuum applications
 Intermediate values can be linearly interpolated

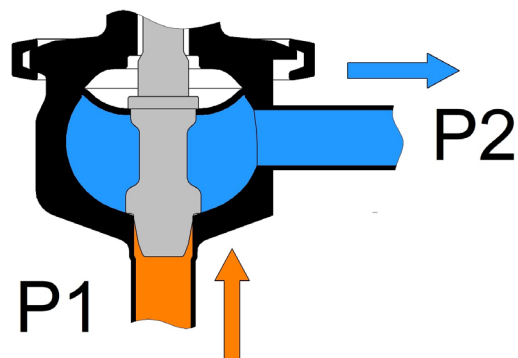

with 3A compliance

KVS values

curve	linear					equal percentage				
	15	20	25	40	50	15	20	25	40	50
nominal size	15	20	25	40	50	15	20	25	40	50
100%	2.6	4	10	23.9	40	2.5	4	9.9	18.3	32
reduced (63%)	2.3	2.3	5.6	16	-	2.5	2.5	6.3	14.5	-
reduced (40%)	1.25	1.25	4	10	-	1.6	1.6	4	-	-
reduced (25%)	1	1	2.3	-	-	-	-	2.5	-	-
reduced (16%)	0.63	0.63	1.25	-	-	-	-	1.6	-	-
reduced (10%)	0.4	0.4	1	-	-	-	-	-	-	-
reduced (6.3%)	0.25	-	0.63	-	-	-	-	-	-	-
reduced (4%)	-	-	0.4	-	-	-	-	-	-	-
reduced (2.5%)	0.1	0.1	-	-	-	-	-	-	-	-
stroke mm	16					16				

order number system

1 2 3 4 5 6 7 8 9 10 11 12 13 14

6 0 5 2 / V M S

1 - 6 : Please enter all 6 digits
7 - 12: Only enter if necessary

Symbol: "V": valve
"R": repair kit (seals)

Type nominal size

1. design	2. Connection	3. Housing	4. Cone, membrane	5. positioner	6. Drive/function	7. special guide
A Hygiene-angle valve	E Welding-the after ASME BPE Z clampstutzen after ASME BPE	7 stainless steel 1.4435 surface roughness inside Ra <0.6 µm 9 stainless steel 1.4435 electro polished Ra < 0.4 µm	P cone out PEEK and membrane made of EPDM with PTFE slide on the fluid side	- without (open/close Valve) C digital position regulator type 8049, 4-wire R digital position regulator type 8049, 2-wire W digital position regulator type 8049, 2-wire Ex version	1 Piston Ø 80mm with Stainless steel-Hood 2 Piston Ø 125mm with Stainless steel-Hood C Membrane-drive D250	M indicate, if more Position occupied become

7. feathers	9. curve	10. Kvs value	11. Accessories	12. more sun deraus-guides	13. positional regulator-variante	14. positional controller setting lung
- default unit R 4 springs (D250) T 6 springs (D250) 1 spring opens	- linear 1 equal procentig	- full (100%) A 1 red. 63% 1 red. 40% 2 red. 25% 3 red. 16% 4 red. 10% 5 red. 6.3% 6 red. 4%	- without	S indicate if further pos. be occupied	C positional controller 8049 with floor plate off stainless steel E positional controller 8049 made of precious steel	- without 1 split range - adjustment as specified of the customer 7 position controller setting 0-10V

15. positional controller supply authorities	16. extensions	17. variant	18. special action	20. special add-on execution
- without N feedback module RM2 Y feedback module RM4	- without	- default 0 drive hood made of stainless steel polished 1 screw exercises and control line made of plastic (PA) 3 screw exercises and control line made of stainless steel 1.4571	- without	

Hygiene corner valve 6052



with 3A compliance

mass and weight

Control valve with piston actuator NC and positioner type 8049

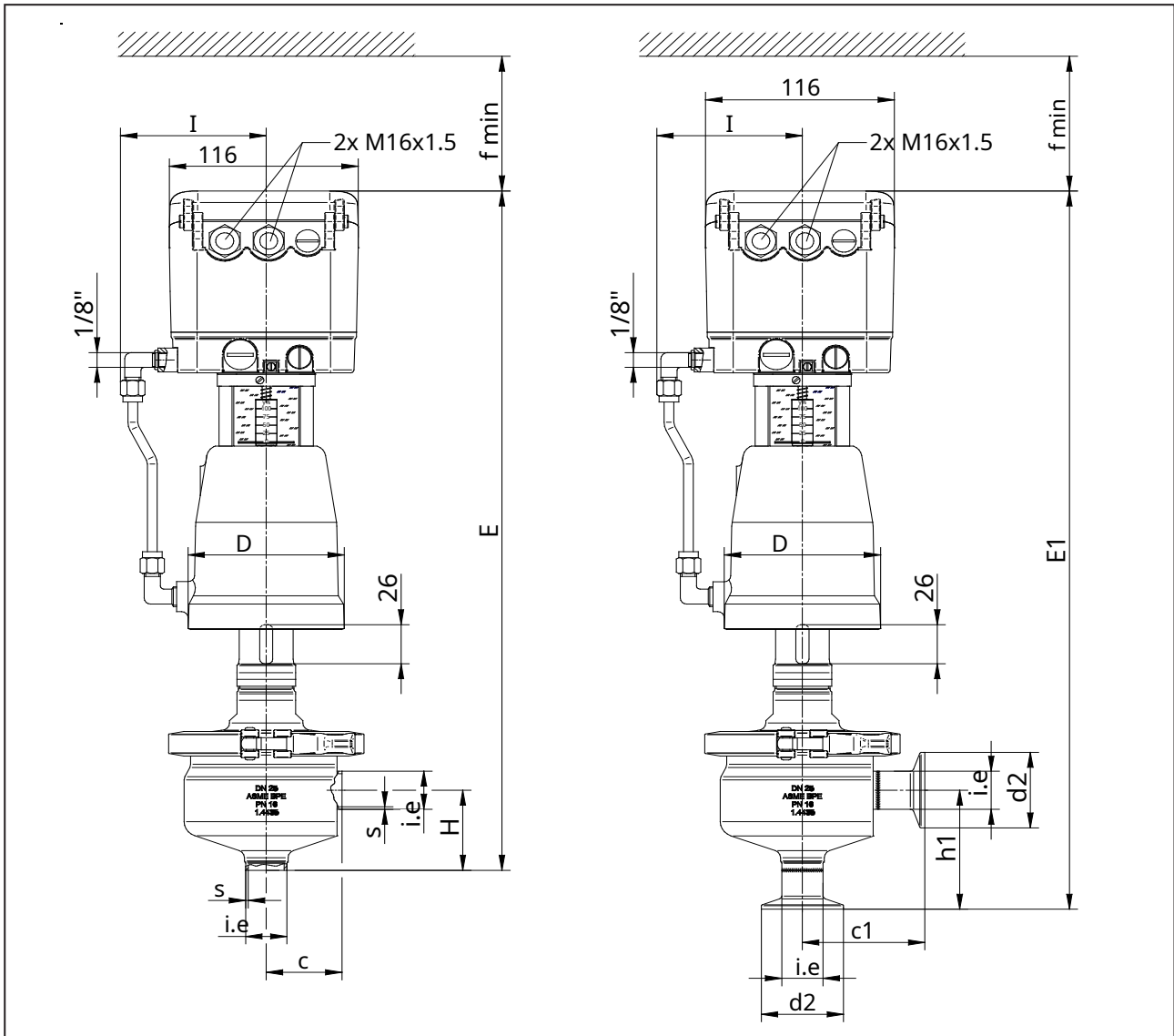

nominal size	drive	D	Butt weld ends to ASME BPE				ASME BPE Tri Clamp			
			s	i.e	c	H	i.e	d2	c1	h1
15	D80	96	1.65	12.7	46.5	61.5	12.7	25	71.5	85.5
20	D80	96	1.65	19.05	46.5	53.5	19.05	25	71.5	83
25	D80	96	1.65	25.4	46.5	53.5	25.4	50.5	75.2	79.5
25	D125	146	1.65	25.4	46.5	53.5	25.4	50.5	75.2	79.5
40	D80	96	1.65	38.1	49.5	54.5	38.1	50.5	87	99
40	D125	146	1.65	38.1	49.5	54.5	38.1	50.5	87	99
50	D80	96	1.65	50.8	51	59	50.8	64	88.9	88.9
50	D125	146	1.65	50.8	51	59	50.8	64	88.9	88.9

nominal size	drive	I	E	E1	f	Weight [kg]
15	D80	90	456.5	480.5	90	7
20	D80	90	451.5	480.5	90	7
25	D80	90	454.5	480.5	90	7.1
25	D125	105	474.5	500.5	90	9.8
40	D80	90	459.5	504.5	100	7.6
40	D125	105	479.5	524.5	100	10.3
50	D80	90	469.5	500.5	120	8th
50	D125	105	489.5	520.5	120	10.7

size in mm

Hygiene corner valve 6052

with 3A compliance

mass and weight

Control valve with NO piston actuator and positioner Type 8049

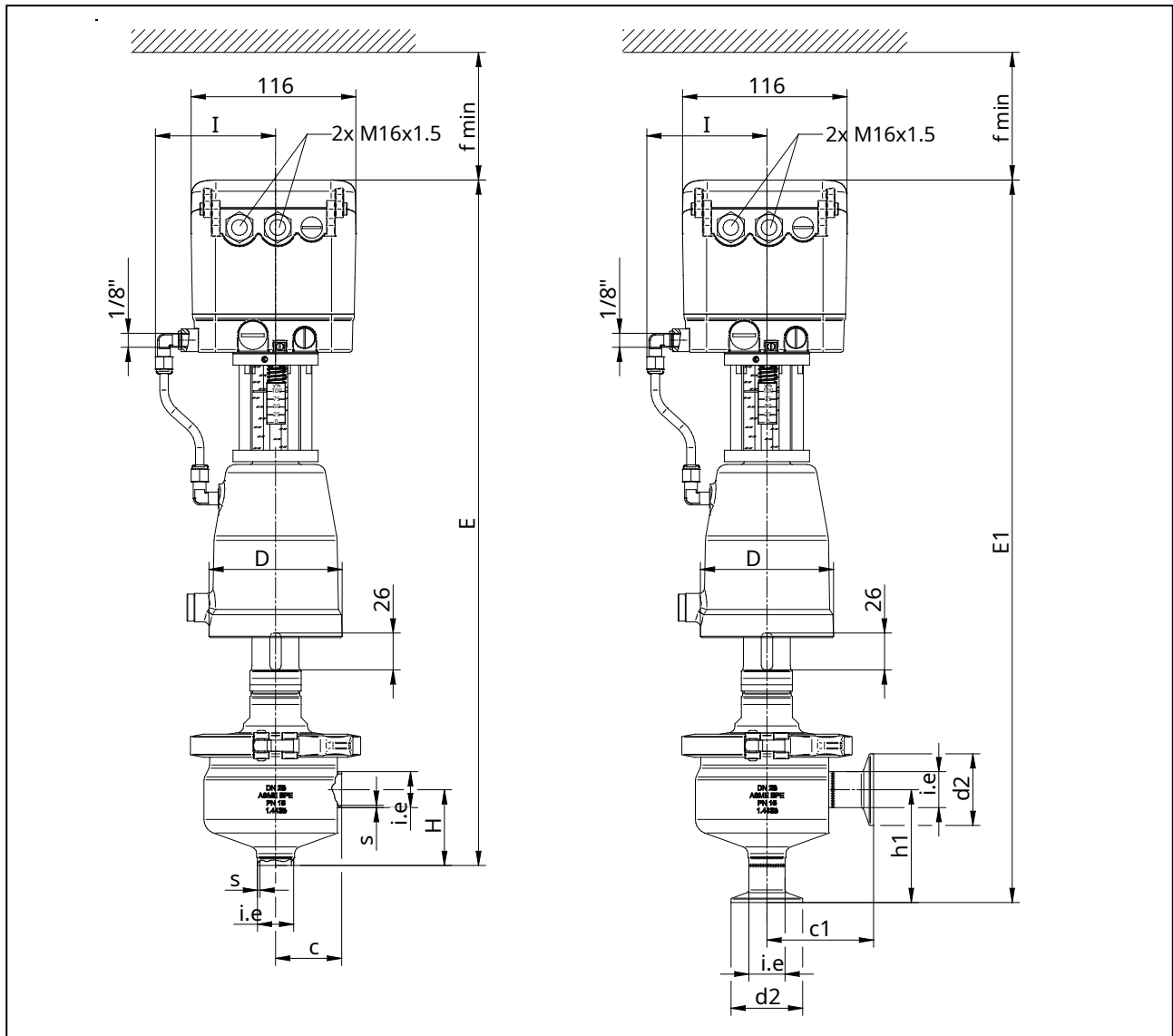

nominal size	drive	D	Butt weld ends to ASME BPE				ASME BPE Tri Clamp			
			s	i.e	c	H	i.e	d2	c1	h1
15	D80	96	1.65	12.7	46.5	61.5	12.7	25	71.5	85.5
20	D80	96	1.65	19.05	46.5	53.5	19.05	25	71.5	83
25	D80	96	1.65	25.4	46.5	53.5	25.4	50.5	75.2	79.5
25	D125	146	1.65	25.4	46.5	53.5	25.4	50.5	75.2	79.5
40	D80	96	1.65	38.1	49.5	54.5	38.1	50.5	87	99
40	D125	146	1.65	38.1	49.5	54.5	38.1	50.5	87	99
50	D80	96	1.65	50.8	51	59	50.8	64	88.9	88.9
50	D125	146	1.65	50.8	51	59	50.8	64	88.9	88.9

nominal size	drive	I	E	E1	f	Weight [kg]
15	D80	90	485.5	480.5	90	7
20	D80	90	480.5	480.5	90	7
25	D80	90	483.5	480.5	90	7.1
25	D125	105	503.5	500.5	90	9.8
40	D80	90	488.5	504.5	100	7.6
40	D125	105	508.5	524.5	100	10.3
50	D80	90	498.5	500.5	120	8th
50	D125	105	518.5	520.5	120	10.7

size in mm

Hygiene corner valve 6052

with 3A compliance

mass and weight

Control valve with diaphragm actuator NC and positioner type 8049

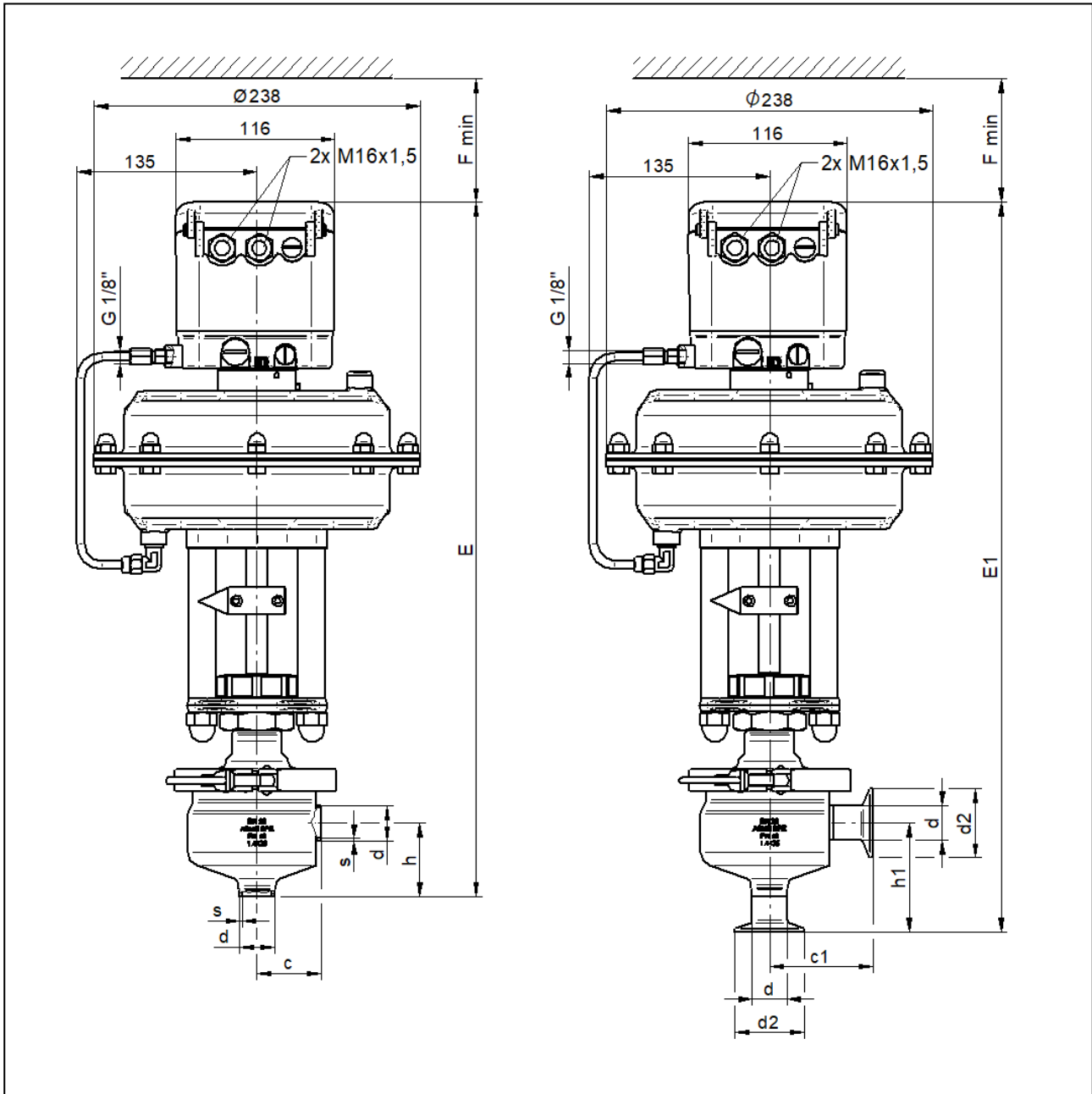

nominal size	drive	Butt weld ends to ASME BPE				ASME BPE Tri Clamp			
		s	i.e	c	H	i.e	d2	c1	h1
15	D250	1.65	12.7	46.5	61.5	12.7	25	71.5	85.5
20	D250	1.65	19.05	46.5	53.5	19.05	25	71.5	83
25	D250	1.65	25.4	46.5	53.5	25.4	50.5	75.2	79.5
40	D250	1.65	38.1	49.5	54.5	38.1	50.5	87	99
50	D250	1.65	50.8	51	59	50.8	64	88.9	88.9

nominal size	drive	E	E1	f	Weight kg
15	D250	510	533	90	15.5
20	D250	505	533	90	15.5
25	D250	508	533	90	15.7
40	D250	513	557	100	16.5
50	D250	523	553	120	16.7

size in mm

Hygiene corner valve 6052



with 3A compliance

mass and weight

Control valve with NO diaphragm actuator and positioner Type 8049

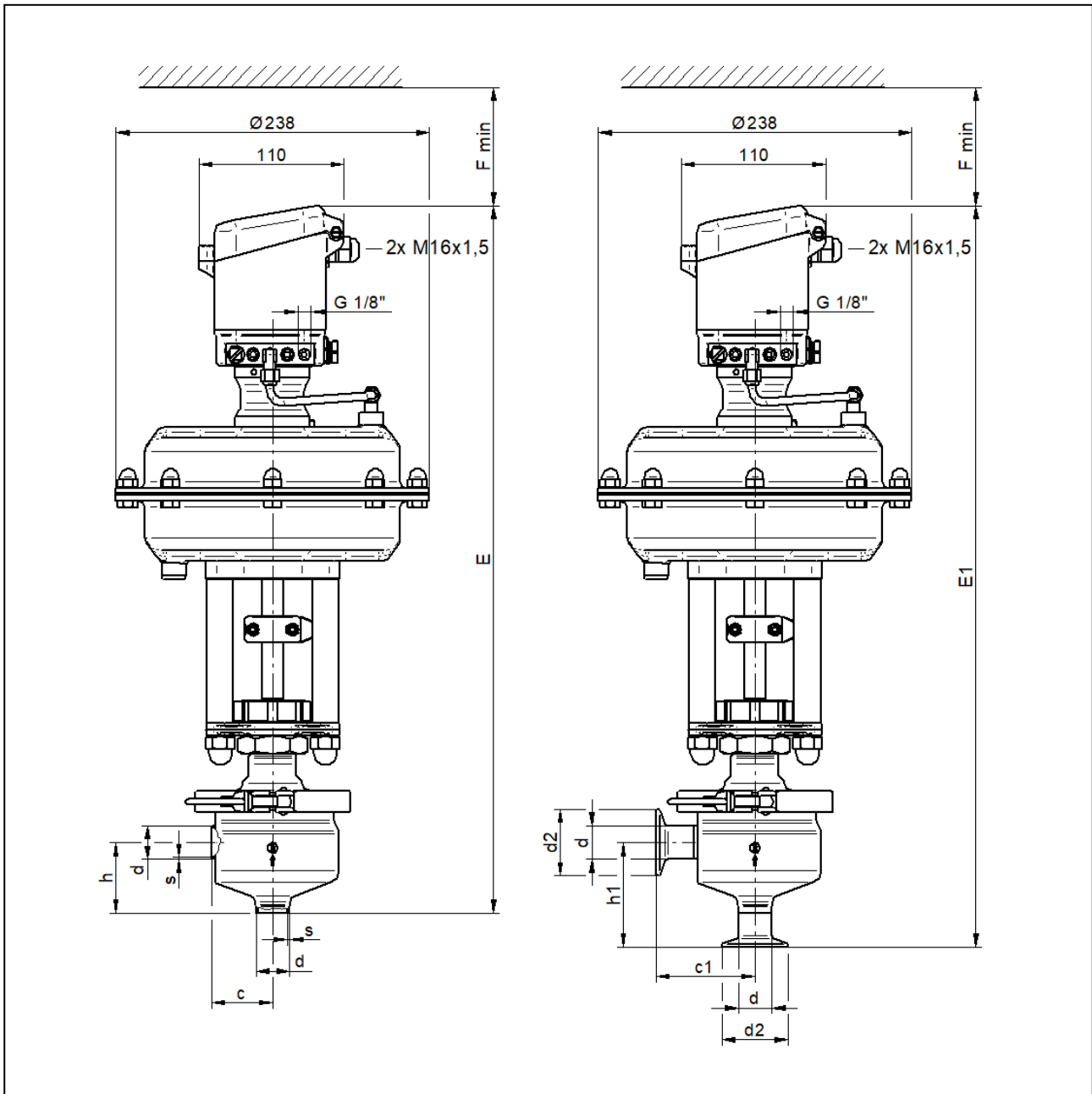

nominal size	drive	Butt weld ends to ASME BPE				ASME BPE Tri Clamp			
		s	i.e	c	H	i.e	d2	c1	h1
15	D250	1.65	12.7	46.5	61.5	12.7	25	71.5	85.5
20	D250	1.65	19.05	46.5	53.5	19.05	25	71.5	83
25	D250	1.65	25.4	46.5	53.5	25.4	50.5	75.2	79.5
40	D250	1.65	38.1	49.5	54.5	38.1	50.5	87	99
50	D250	1.65	50.8	51	59	50.8	64	88.9	88.9

nominal size	drive	E	E1	f	Weight kg
15	D250	541	563	90	15.5
20	D250	536	563	90	15.5
25	D250	539	563	90	15.7
40	D250	544	587	100	16.5
50	D250	554	583	120	16.7

size in mm

Hygiene corner valve 6052

with 3A compliance

mass and weight

Shut-off valve with NC piston drive

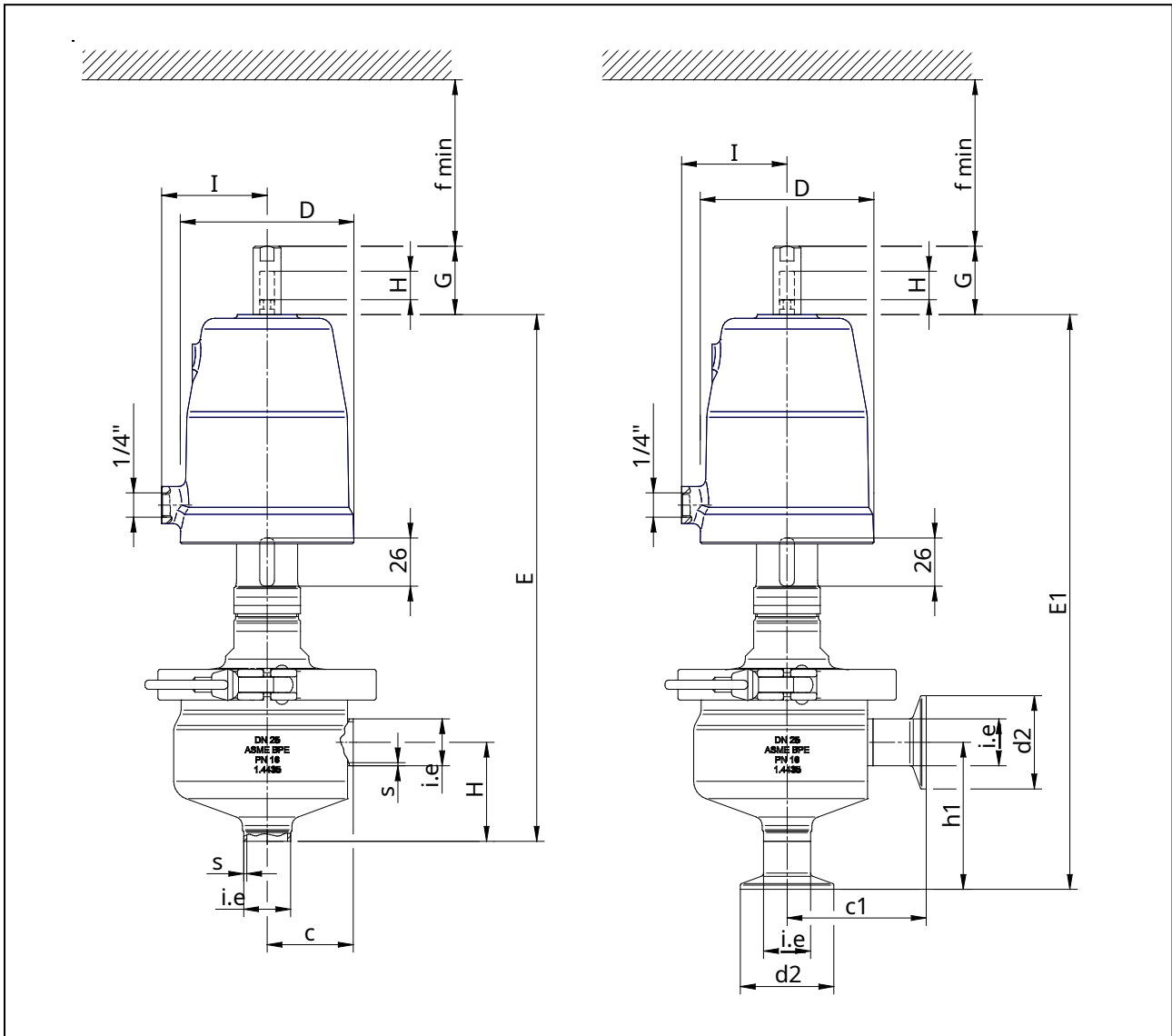

nominal size	drive	D	Butt weld ends to ASME BPE				ASME BPE Tri Clamp			
			s	i.e	c	H	i.e	d2	c1	h1
15	D80	96	1.65	12.7	46.5	61.5	12.7	25	71.5	85.5
20	D80	96	1.65	19.05	46.5	53.5	19.05	25	71.5	83
25	D80	96	1.65	25.4	46.5	53.5	25.4	50.5	75.2	79.5
25	D125	146	1.65	25.4	46.5	53.5	25.4	50.5	75.2	79.5
40	D80	96	1.65	38.1	49.5	54.5	38.1	50.5	87	99
40	D125	146	1.65	38.1	49.5	54.5	38.1	50.5	87	99
50	D80	96	1.65	50.8	51	59	50.8	64	88.9	88.9
50	D125	146	1.65	50.8	51	59	50.8	64	88.9	88.9

nominal size	drive	I	E	E1	G	H (hub)	f	Weight [kg]
15	D80	90	287	313	37	16	90	6
20	D80	90	282	308	37	16	90	6
25	D80	90	285	311	37	16	90	6
25	D125	105	309	335	37	16	90	8.8
40	D80	90	291	317	37	16	100	6.6
40	D125	105	315	341	37	16	100	9.3
50	D80	90	301	327	37	16	120	7
50	D125	105	325	351	37	16	120	9.7

size in mm

Hygiene corner valve 6052

with 3A compliance

mass and weight

Shut-off valve with piston actuator NO

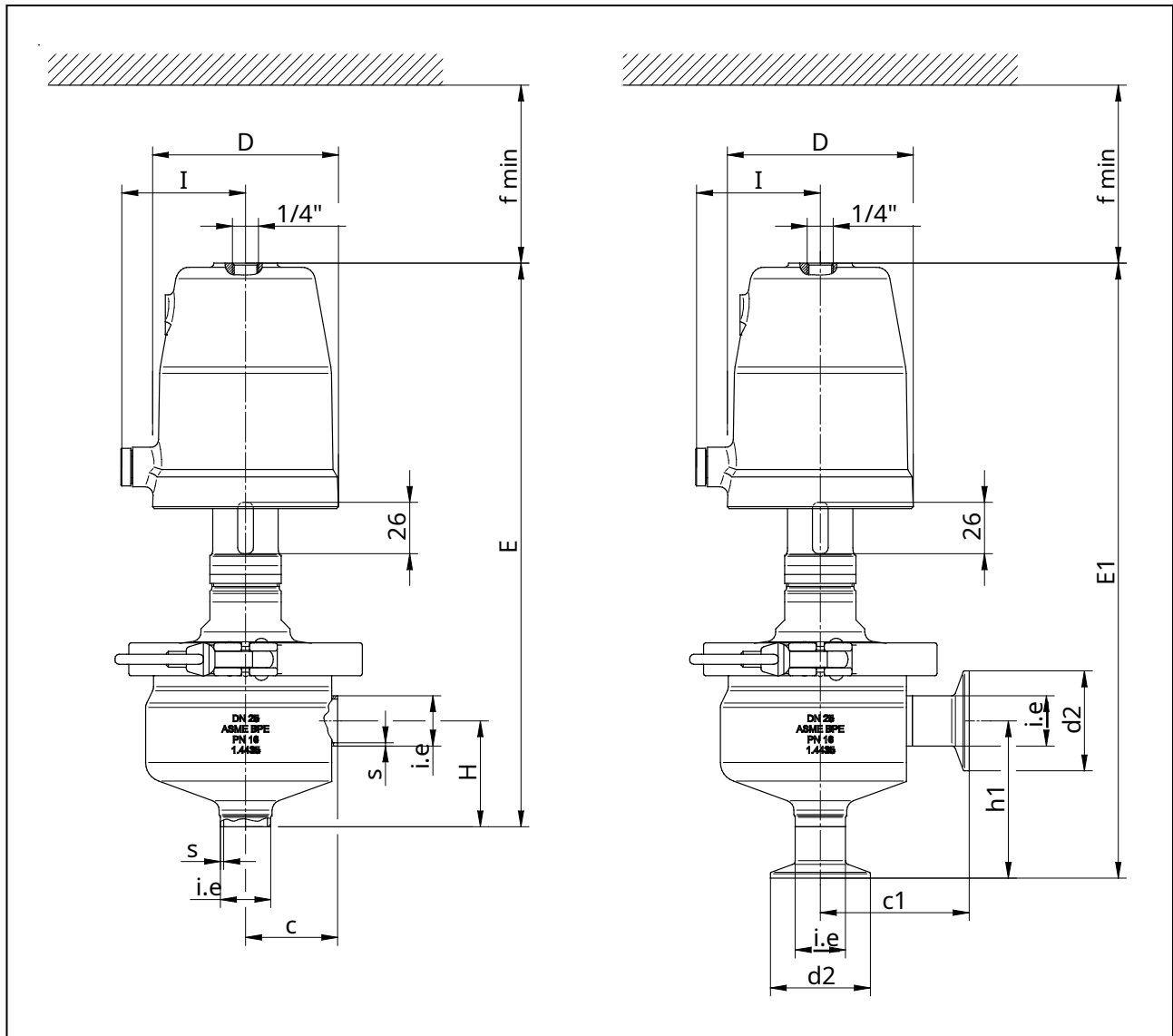

nominal size	drive	D	Butt weld ends to ASME BPE				ASME BPE Tri Clamp			
			s	i.e	c	H	i.e	d2	c1	h1
15	D80	96	1.65	12.7	46.5	61.5	12.7	25	71.5	85.5
20	D80	96	1.65	19.05	46.5	53.5	19.05	25	71.5	83
25	D80	96	1.65	25.4	46.5	53.5	25.4	50.5	75.2	79.5
25	D125	146	1.65	25.4	46.5	53.5	25.4	50.5	75.2	79.5
40	D80	96	1.65	38.1	49.5	54.5	38.1	50.5	87	99
40	D125	146	1.65	38.1	49.5	54.5	38.1	50.5	87	99
50	D80	96	1.65	50.8	51	59	50.8	64	88.9	88.9
50	D125	146	1.65	50.8	51	59	50.8	64	88.9	88.9

nominal size	drive	I	E	E1	H (hub)	f	Weight [kg]
15	D80	90	287	313	16	90	6
20	D80	90	282	308	16	90	6
25	D80	90	285	311	16	90	6
25	D125	105	309	335	16	90	8.8
40	D80	90	291	317	16	100	6.6
40	D125	105	315	341	16	100	9.3
50	D80	90	301	327	16	120	7
50	D125	105	325	351	16	120	9.7

size in mm

Hygiene corner valve 6052

with 3A compliance

mass and weight

Shut-off valve with NC diaphragm actuator

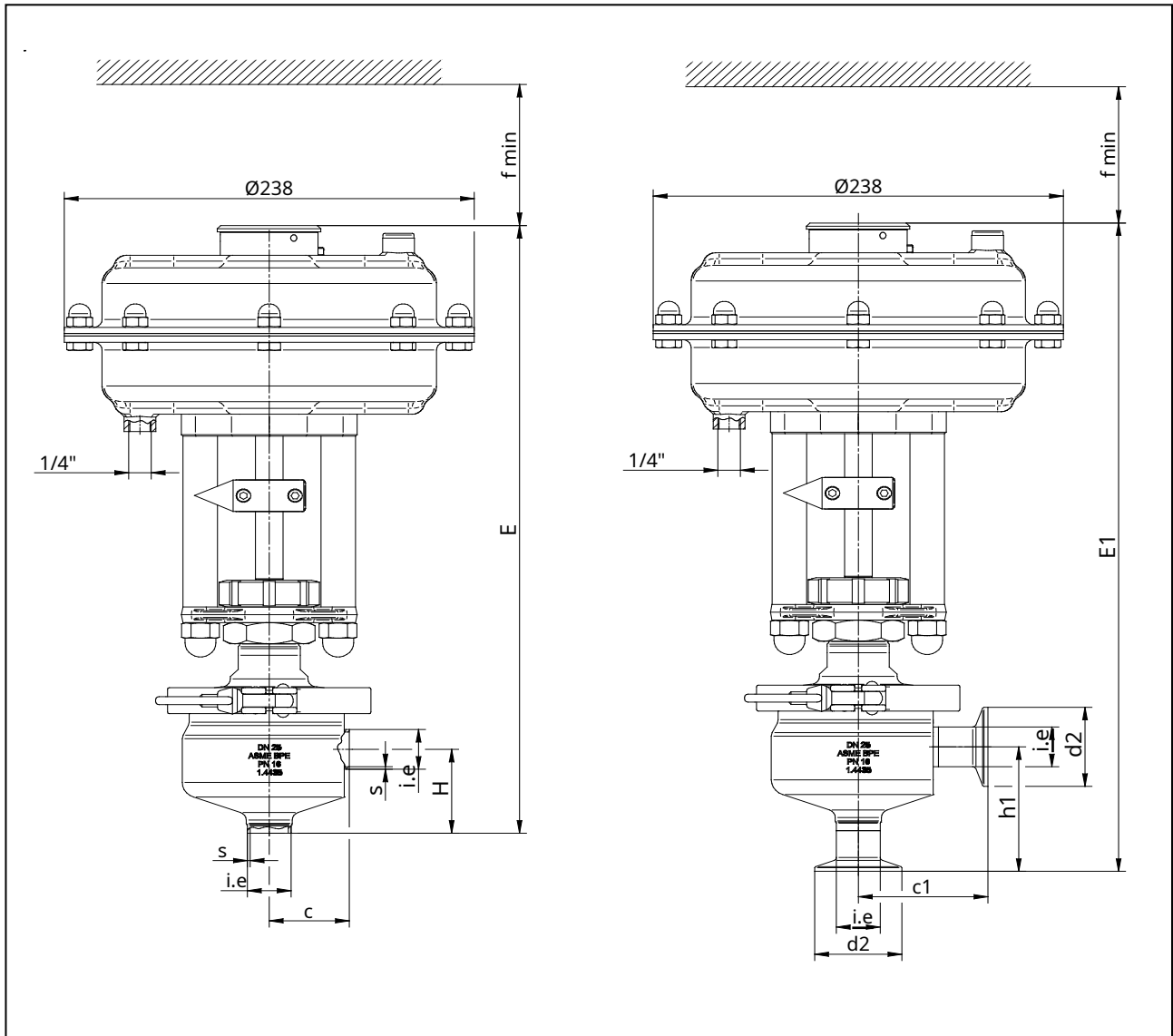

nominal size	drive	Butt weld ends to ASME BPE				ASME BPE Tri Clamp			
		s	i.e	c	H	i.e	d2	c1	h1
15	D250	1.65	12.7	46.5	61.5	12.7	25	71.5	85.5
20	D250	1.65	19.05	46.5	53.5	19.05	25	71.5	83
25	D250	1.65	25.4	46.5	53.5	25.4	50.5	75.2	79.5
40	D250	1.65	38.1	49.5	54.5	38.1	50.5	87	99
50	D250	1.65	50.8	51	59	50.8	64	88.9	88.9

nominal size	drive	E	E1	f	Weight kg
15	D250	392	401	90	15.5
20	D250	387	401	90	15.5
25	D250	390	401	90	15.7
40	D250	395	425	100	16.5
50	D250	405	420	120	16.7

size in mm

Hygiene corner valve 6052



with 3A compliance

mass and weight

Shut-off valve with diaphragm actuator NO

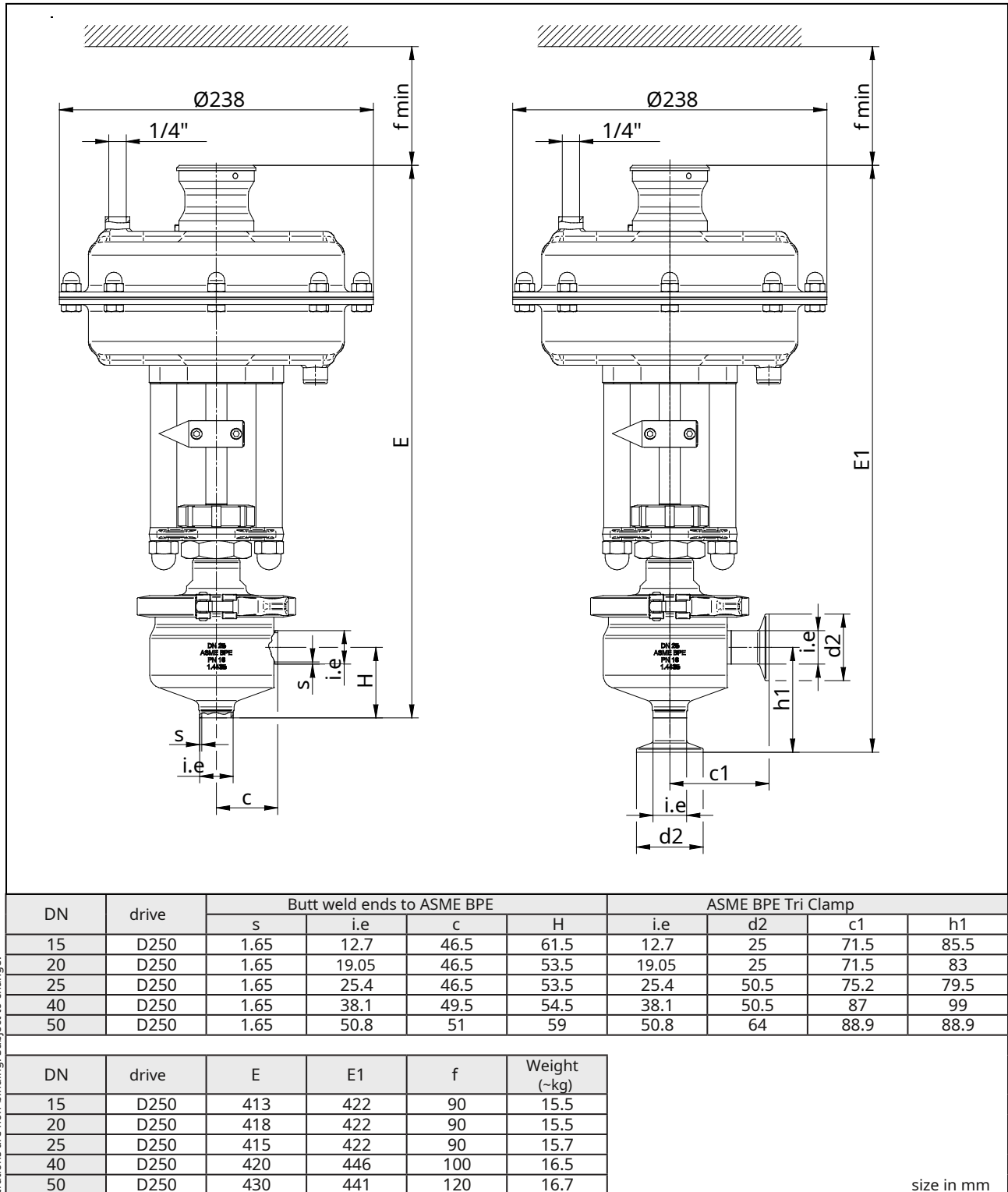

Information and illustrations are non-binding. Subject to change.