

SM... float switches

The rising or falling liquid level causes the float to move slightly up or down. When the float rises, it activates a microswitch (changeover contact).

versions also available. Detailed information on request.

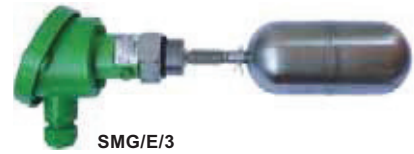

Technical data	SM/P/3	SMG/P/3	SM/E/3	SMG/E/3
Application	for applications up to max. 250 V			
Switching voltage	between AC/DC 24 V and AC/DC 250 V			
Switching current	between AC 20 mA and AC 5 (1) A			
Switching capacity	or between DC 20 mA and DC 100 mA max. 1,000 VA			
Operating principle	microswitch, changeover contact			
Bellows material	PP	PP	stainless steel 316 Ti	stainless steel 316 Ti
Float material	cylindrical float	cylindrical float	cylindrical float	cylindrical float
Float dimensions	Ø 29 mm x 133 mm long	Ø 63 mm x 140 mm long; on request: ball float Ø 85 mm	Ø 28 mm x 120 mm long	Ø 63 mm x 140 mm long on request: ball float Ø 95 mm
On request: extension piece for the float	—	—	—	horizontal or vertical
Screw-in nipple	PP, G1	—	—	stainless steel 316 Ti, G1
Flange	PP, PVDF, steel St 37 or stainless steel 316 Ti	on request: square blind flange with G1 threaded hole made of PP, PVDF, steel St 37 or stainless steel 316 Ti	—	steel St 37 or stainless steel 316 Ti
Float protection class	IP 68			
Connection head	PP with M 20 x 1.5 cable entry, protection class IP 54; on request: connection head made of cast aluminium, protection class IP 54			
Mounting orientation	horizontal			
Temperature application range	from 0°C to + 90°C		from 0°C to + 100°C	
	(inside the connection head: from 0°C to + 60°C)			
Pressure resistance	for pressureless applications			
Test pressure	max. 2 bar at + 20°C (without flange or with flange made of steel or stainless steel; with square flange made of PP or PVDF: 0 bar)		—	
Application	≥ 0.82 g/cm ³	only for use in liquids with a specific gravity ≥ 0.7 g/cm ³		≥ 0.7 g/cm ³ (without extension piece)

SM/P/3

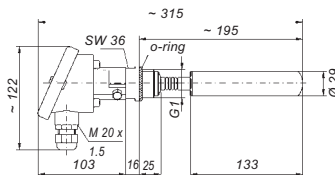

SMG/P/3

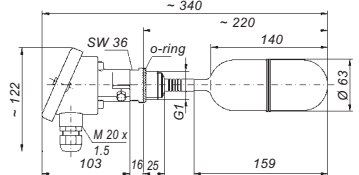

SM/E/3

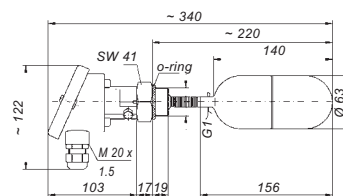
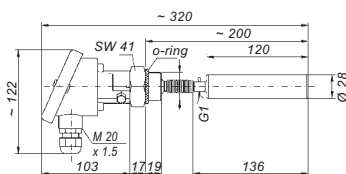

SMG/E/3